



Situated within the Eastbourne area Tunstall Terrace, just off Geneva Road, Darlington, this modern terraced house presents an excellent opportunity for families seeking a comfortable and spacious home.

Upon entering, you will find an inviting reception room that offers ample space for relaxation and entertaining. The refitted kitchen/diner which offers a host of appliances is perfect for all the family to gather, opens into the garden room, with delightful views over the rear garden, and serves as a perfect retreat for family gatherings or quiet evenings at home. The garden itself provides a lovely outdoor space for children to play or for hosting summer barbecues.

The property boasts three well-proportioned bedrooms, making it ideal for family living. The bathroom and downstairs WC provide convenience, catering to the needs of a busy household.

This property has been thoughtfully upgraded throughout, ensuring a contemporary feel while maintaining its charm. Its competitive pricing makes it an attractive option for those looking to settle in a vibrant community. The location is particularly advantageous, as it is within walking distance to local shops, schools, and other essential amenities, making daily life both convenient and enjoyable.





- IMPRESSIVE THREE BEDROOMED PROPERTY
- READY TO MOVE INTO
- FITTED KITCHEN WITH APPLIANCES
- HANDY GROUND FLOOR CLOAKS/WC
- CONSERVATORY WITH NEW ROOF
- MATURE, ESTABLISHED GARDENS
- SUITED TO A VARIETY OF BUYERS
- EASY ACCESS TO SHOPS, SCHOOLS AND THE TOWN CENTRE BEING MINUTES DRIVE

GENERAL INFORMATION

Tenure: Freehold

Services: Electric central heating, mains electric, water and drainage.

Double glazing

Local Authority: Darlington Borough Council (Tax Banding A)

*Buyers please note that there is a shared side access.

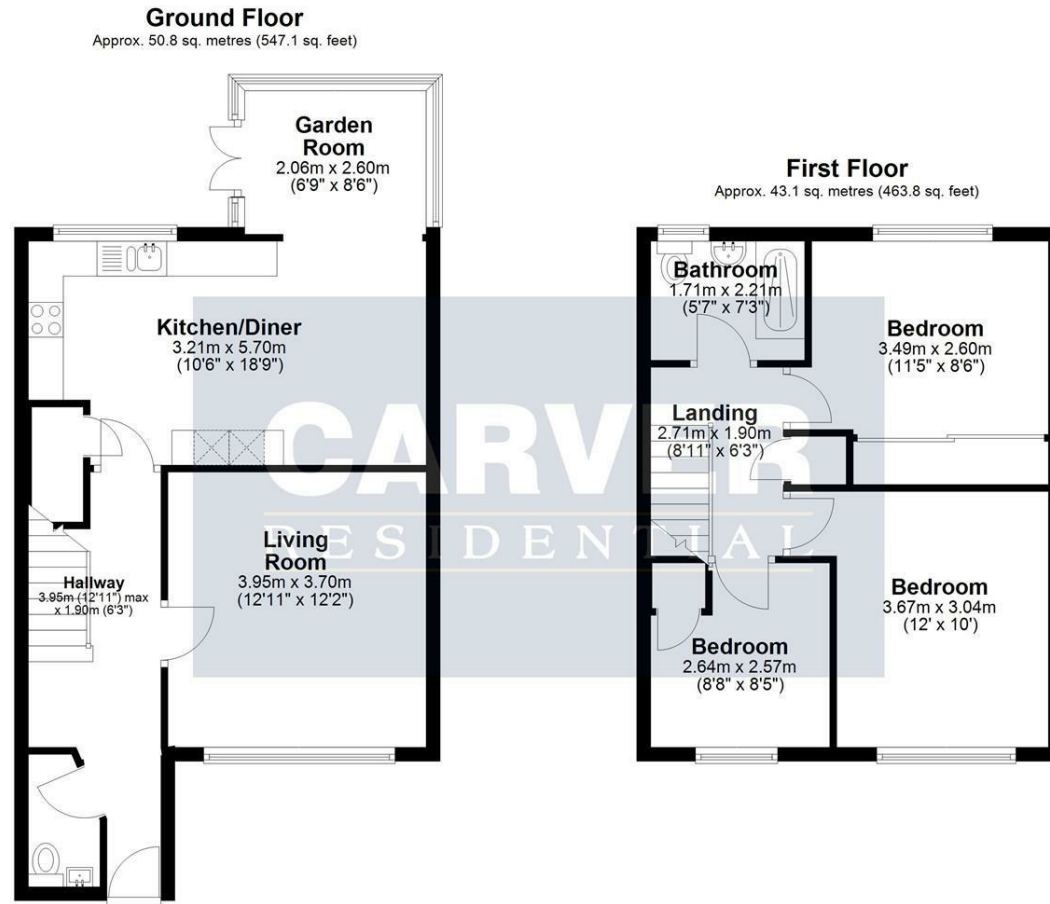

Energy Efficiency Rating		
Very energy efficient - lower running costs		
(92 plus) A		
(81-91) B		
(69-80) C		
(55-68) D		
(39-54) E		
(21-38) F		
(1-20) G		
Not energy efficient - higher running costs		
England & Wales		EU Directive 2002/91/EC

Total area: approx. 93.9 sq. metres (1011.0 sq. feet)
5 Tunstall Terrace, Darlington

We can search 1,000s of mortgages for you

It could take just 15 minutes with one of our specialist advisers:
Call: 01325 380088. Visit: Any of our Offices. Online: www.mortgageadvicebureau.com/carver



Your home may be repossessed if you do not keep up repayments on your mortgage.
There will be a fee for mortgage advice. The actual amount you pay will depend upon your circumstances.
The fee is up to 1% but a typical fee is 0.3% of the amount borrowed

MAB 6202



These particulars do not constitute any part of an offer or contract. None of the statements contained in these particulars are to be relied on as statements or representations of fact and any intending purchaser must satisfy himself by inspection or otherwise to the correctness of each of the statements contained in these particulars. The vendor does not make or give, and neither Nick & Gordon Carver Residential or Commercial, Nick & Gordon Carver, nor any person in their employment has any authority to make or give any representation or warranty whatever in relation to this property



14 Duke Street, Darlington
Co Durham, DL3 7AA
01325 357807
sales@carvergroup.co.uk

63 Dalton Way, Newton Aycliffe
Co Durham DL5 4NB
01325 320676
aycliffe@carvergroup.co.uk

41 Market Place, Richmond
North Yorkshire, DL10 4QL
01748 825317
richmond@carvergroup.co.uk

219 High Street, Northallerton
North Yorkshire DL7 8LW
01609 777710
northallerton@carvergroup.co.uk